

49	water pump shock pad	RF-DA65BZJ01	Ø25*40mm	1
48	Chassis cover	RF-DA65AWJ03	Ø25*40mm	1
47	water pump bracket	RF-DA65AWJ04	Ø25*40mm	1
46	Pump	RF-BZJDQ89	Ø25*40mm	1
45	water pipe	RF-BZJWJ45	Ø25*40mm	2
44	copper joint	RF-DWA85PWJ14	Ø25*40mm	1
43	square buckle	RF- BZJSJ01	Ø25*40mm	1
42	hinge	RF- BZJWJ03	Ø25*40mm	2
41	electric control box	RF- DWA60PWJ09	Ø25*40mm	1
40	main control board	RF- DWA90PDQ04	Ø25*40mm	1
39	capacitor clip	RF- DGA50PSJ02	Ø25*40mm	1
38	capacitor	RF- BZJDQ38	Ø25*40mm	1
37	network connection wire	RF- DWA90PDQ09	Ø25*40mm	1
36	A1-A6 fence row set	RF- DWA60PDQ15	Ø25*40mm	1
35	back cover board	RF- DWA60PWJ02	Ø25*40mm	1
34	display operating panel	RF- DWA90PDQ13	Ø25*40mm	1
33	control panel	RF- DWA60PSJ02	Ø25*40mm	1
32	air outlet board	RF- DWA90PSJ10	Ø25*40mm	1
31	plastic door holder	RF- BZJSJ13	Ø25*40mm	1
30	motor	RF- DWA60PDQ06	Ø25*40mm	1
29	left side board	RF- DWA60PWJ07	Ø25*40mm	1
28	volute	RF- DWA60PWJ11	Ø25*40mm	1
27	centrifugal wind wheel	RF- DWA60PWJ12	Ø25*40mm	1
26	nut	standard component	Ø25*40mm	1
25	humidity sensor	RF- DWA90PDQ05	Ø25*40mm	1
24	motor capacitor	RF- BZJDQ34	Ø25*40mm	1
23	floating ball	RF-BZJDQ9	Ø25*40mm	1
22	floating ball fixing plate	RF-DA65AWJ05	Ø25*40mm	1
21	chassis	RF- DWA60PWJ05	Ø25*40mm	1
20	adjustable food pad	RF- BZJWJ20	Ø25*40mm	4
19	water collector	RF- DWA60PSJ01	Ø25*40mm	1
18	front cover board	RF- DWA60PWJ03	Ø25*40mm	1
17	sleeve	RF- BZJJGJ02- 1	Ø25*40mm	3
16	compressor foot pad	standard component	Ø25*40mm	3
15	bolt	standard component	Ø25*40mm	3
14	compressor bracket	RF- DWA60PWJ15	Ø25*40mm	1
13	compressor	RF- BZJDQ15	Ø25*40mm	1
12	filter	RF- DWA55PXT09	Ø25*40mm	1
11	G3 filter	RF- DWA60PWJ16	Ø25*40mm	1
10	capillary	RF- DWA55PXT013	Ø25*40mm	1
9	low pressure pipe	RF- DWA55PXT011	Ø25*40mm	1
8	high pressure pipe	RF- DWA55PXT010	Ø25*40mm	1
No.	Name	Model	Material	Quantity

7	right side board	RF- DWA60PWJ08	228.5*50*8mm	1
6	cool and heat exchanger	RF- DWA55PXT01	component	1
5	exchanger cover board	RF- DWA60PWJ06	228.5*50*8mm	1
4	conducting bar	RF- DWA60PWJ04	453*28*2.3mm	1
3	main body	RF- DWA60PWJ01	455*302*299mm	1
2	handle	RF- DWA60PWJ17	270	2
1	screw	component	M4	8
No.	Name	Model	Material	Quantity

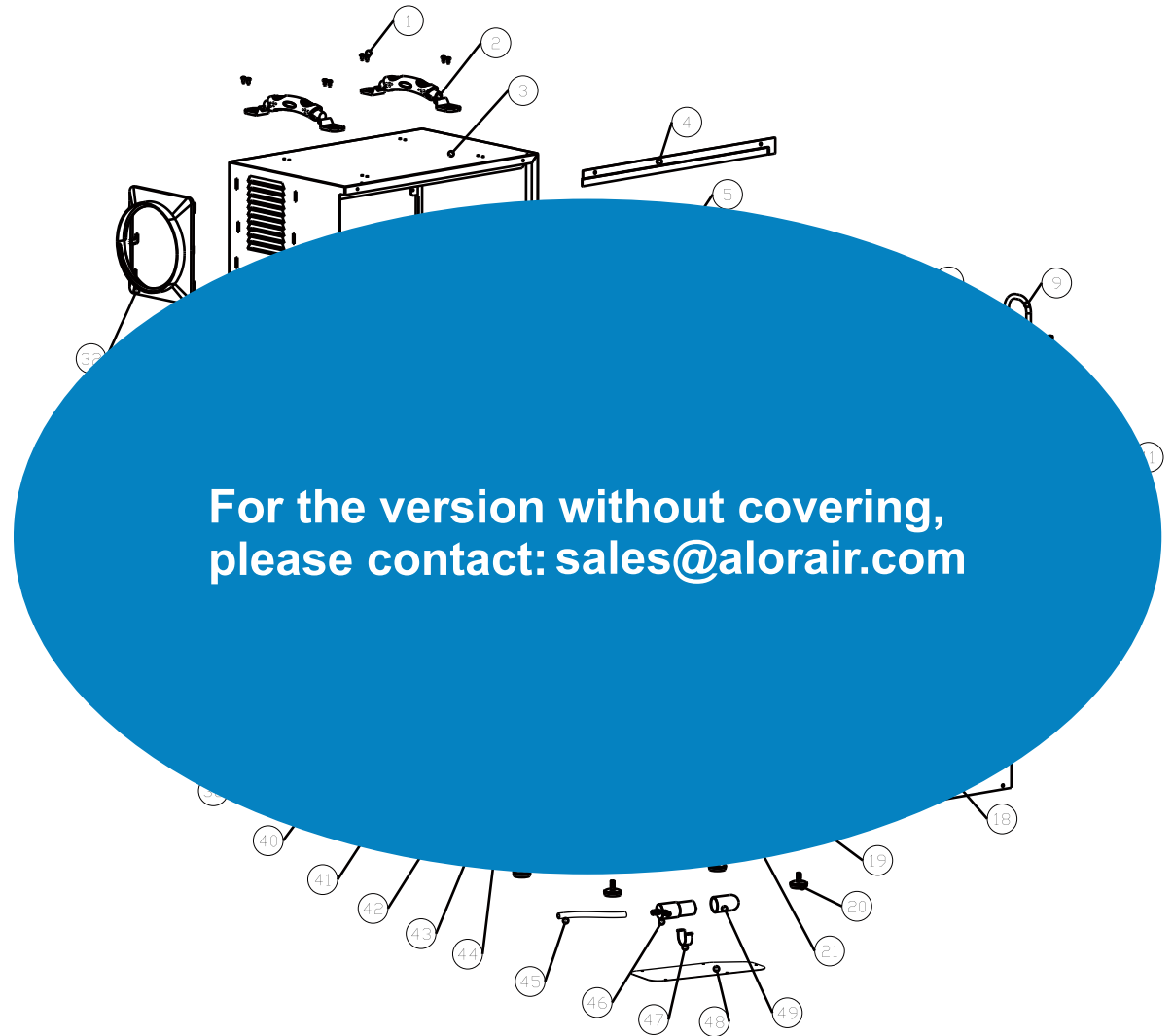

— Restoration&Moisture&Ventilation —

**ALORAIR**

**SPARE PARTS LIST**

**Sentinel HDi65S**